

# CCBB - TEATRO II

## 2º ANDAR



PALCO ..... 73,94M<sup>2</sup>

PLATÉIA ..... 128,48M<sup>2</sup>

ÁREA TOTAL ..... 286,50M<sup>2</sup>

## 2,5 ANDAR

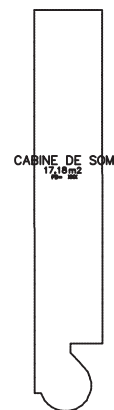
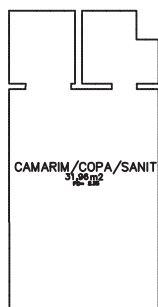

CAMARINS/COPA/SANIT ..... 31,96M<sup>2</sup>

CABINE DE SOM ..... 17,18M<sup>2</sup>

ÁREA TOTAL ..... 49,14M<sup>2</sup>

ÁREA TOTAL DO TEATRO II = 335,64M<sup>2</sup>